

Castles

ASSEMBLY INSTRUCTIONS for PO293

Curtain Walls

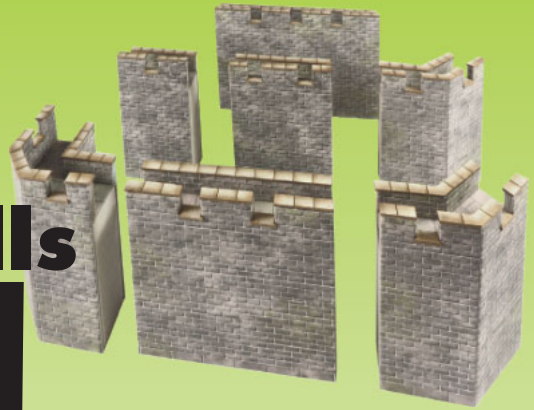

PLEASE - PAY ATTENTION

Read through the instructions and familiarise yourself with the kit components before you start any building.

You must follow these step by step instructions carefully to make this wonderfully detailed kit.

1 Tools to build this kit.

To build this kit you will need a few basic tools:

1. A modellers knife.
2. A cutting surface - A cutting mat or a sheet of thick card will do.
3. A sharp pair of scissors
4. A steel ruler.
5. Fine point tweezers.
6. Something to clamp surfaces together, Bulldog clips are good for this job.
6. METCALFE Ultra Fine Tip Glue Bottles (see 3)

2 Glue.

We recommend using a combination of two types of glue: **Speed Bond** and **Rocket Card Glue**. Both are made by Deluxe Materials -

www.deluxematerials.com

Rocket Card Glue is an instant and fast drying glue, great for where you need stuff to stay just where you place it.

Supplied with its own fine tip applicator.

Speed Bond is slightly slower drying, ideal for where a little positioning is required as you build.



3 Ultra Fine Tip Glue Applicators.

An absolute 'must' when building this kit. When used with Speed Bond perfect amounts of glue can be applied to very precise areas without any mess.



Speed Bond in an applicator was used to build most of this kit.

A METCALFE product supplied in packs of 3
Product code MT907
Glue not included



4 Extracting components from base sheets.

To stop the components falling off the base sheets, they are held secure with score lines (marked with blue arrows) that cut about 75% of the way through the card.

To release them run the point of your knife along these score lines and they will come seamlessly away.

WARNING, Cut with care to reduce the risk of the blade running out of the score and cutting the component.

5 Kit components. This kit contains:



SHEET A.
Printed sheet with components for short, medium and long walls. Also 45° corner walls.



SHEET B.
Printed sheet with components for extra long wall, 90° corner wall and 45° corner wall. Also a wall end unit.

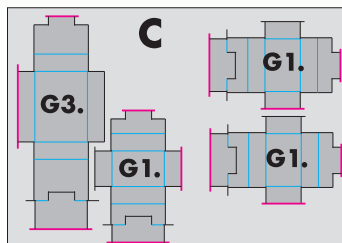

GREY CARD SHEETS C. & D.

Thick card components that fold together to form box type structures for strengthening the walls.

Key to Grey Card Components:

- G1. 3 x Small inner strengtheners. One for the Short Wall and two for the Extra Long Wall.
- G2. Medium Wall inner strengthener.
- G3. Long Wall inner strengthener.
- G4. 45° Corner Wall inner strengtheners x 2.
- G5. 90° Corner Wall inner strengthener.

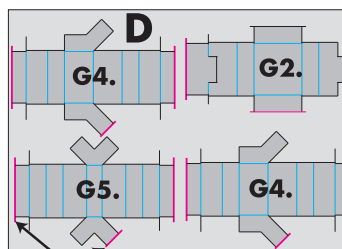

RED lines indicate score rules you need to cut to release from base sheet.
BLUE lines are fold lines. Don't cut

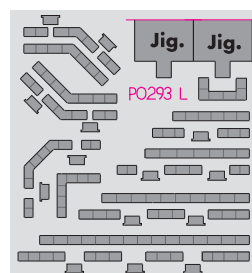

LASER CUT SHEET L1.

On this sheet are the tiny laser cut parts that make this kit look so good. There are:

14 x Crenel stones.

29 x Various Merlon top stones.

Jig for assembling battlements x 2.

6 Technical Stuff.

Castle Wall Terminology.
Just so you know.

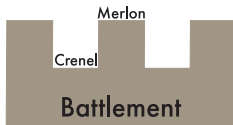

7 Overview.

In this kit there are 4 various lengths of straight curtain walls, one 90° corner and two 45° corners. Each one is built in the same way around a central box structure (inner strengthener).

Front wall and rear wall attached to each side of the strengthener. Paving strip then placed on top edge.

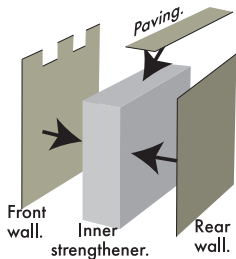

Three layers of card make each inner wall that attach to the back of the outer walls.

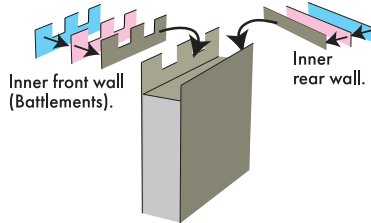

Wall tops and battlements are then topped off with laser cut capping stones. see 14

8 Inner Strengtheners (Straight Walls).

Starting with the two GREY CARD SHEETS C. & D.

Extract all eight inner strengtheners (G1. to G5.)

Make the five oblong boxes (G1. to G3.) first. They all make up in exactly the same way.

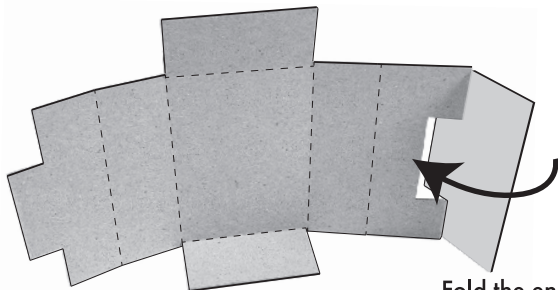

Fold the end section around and fix to the back of the next piece of card.

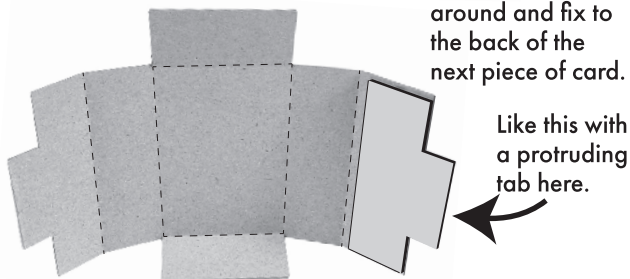

Like this with a protruding tab here.

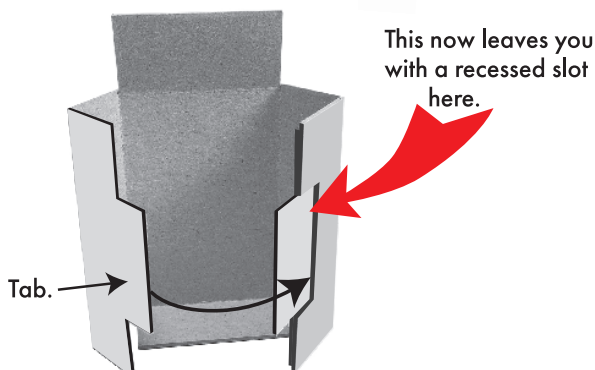

This now leaves you with a recessed slot here.

Tab.

The sides fold around and the tab on the left fits tightly into the slot on the right hand side, bringing the two halves of the wall together. Fix with glue on the back of the tab.

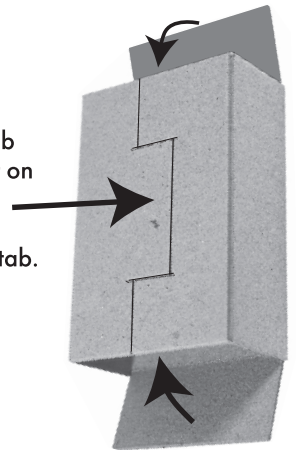

Fold top down.

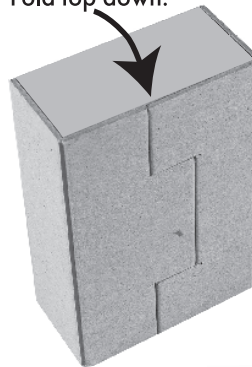

Finally fold in the top and bottom flaps so they sit down inside the outer walls fixed onto the inner card you folded in earlier.

Make up the other different sized boxes and place to one side.

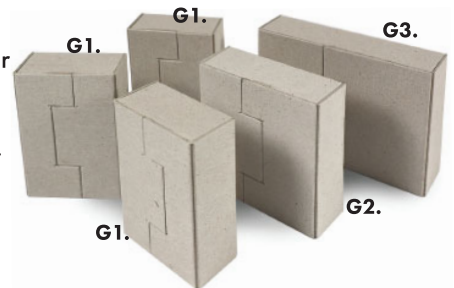

9 Inner Strengtheners (Corner Walls).

The 45° Corner Inner Strengthener

Fold in the two end flaps and glue back.

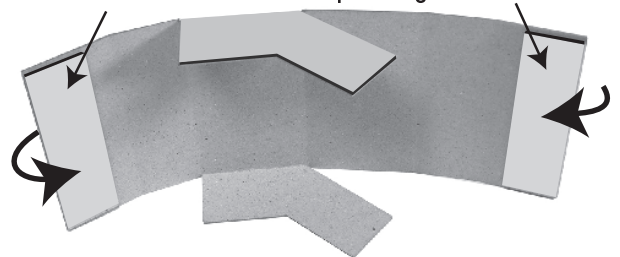

Top pushed down inside onto inner flap.

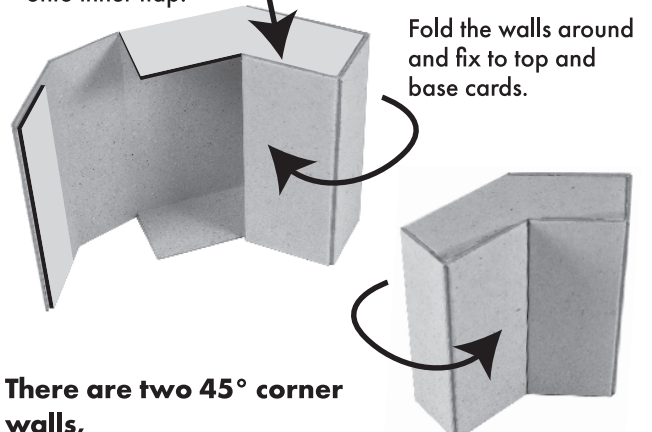

Fold the walls around and fix to top and base cards.

There are two 45° corner walls,

The 90° Corner Inner Strengthenener

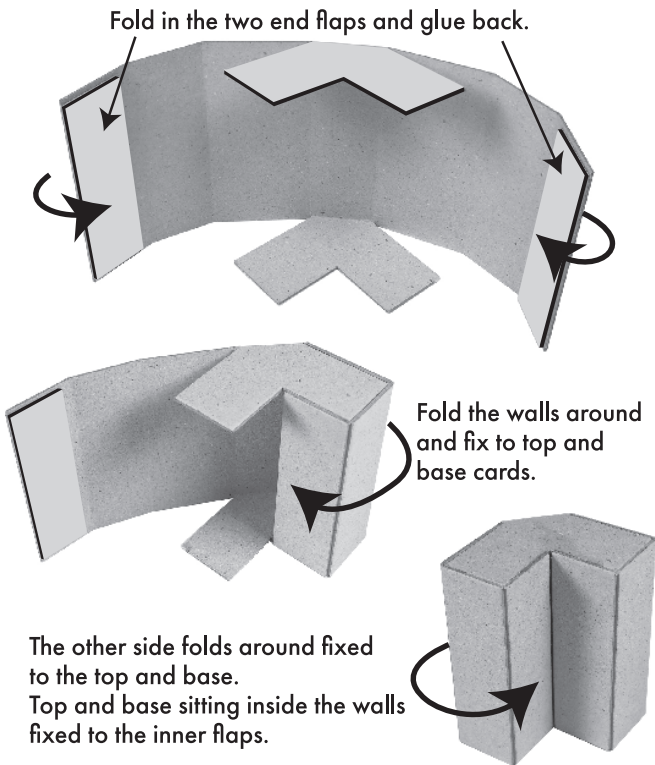

to Fitting the Outer Walls.

Starting with the LONG straight wall.

All the walls have an outer section and an inner section which are simply attached to their corresponding inner box.

From **SHEET A.** extract:

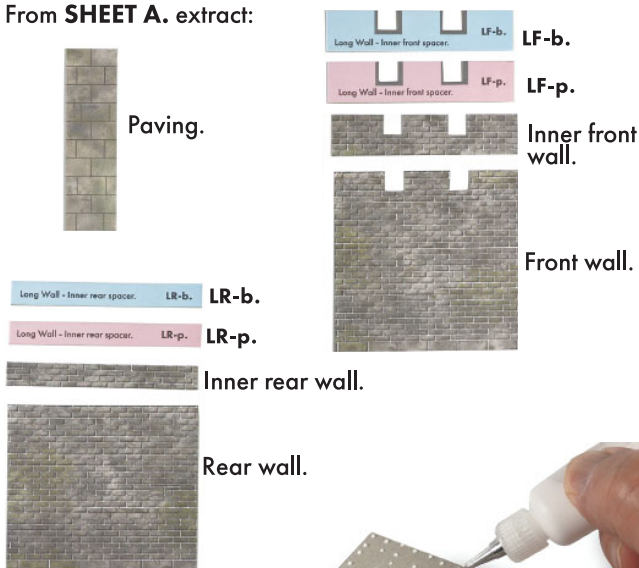

Place spots of glue over the surface of the large box. Close to the edges.

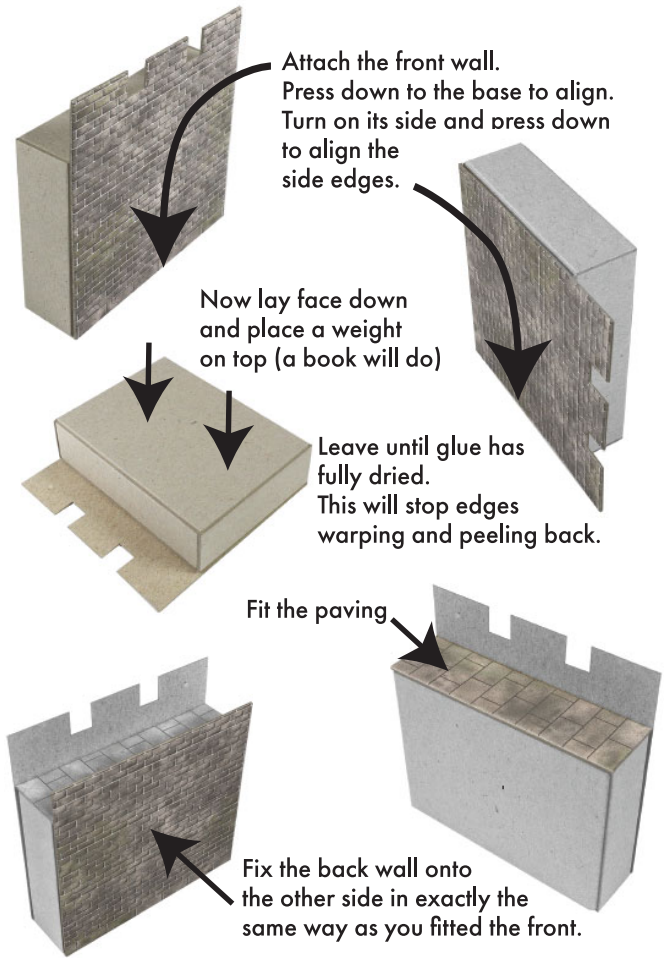

Again, place under a weight to hold flat until glue has set.

to Inner Walls & Battlements.

Each inner wall throughout this kit all consist of three layers.

Fix Pink spacer **LF-p.** to the back of the **Inner front wall.** Then fix Blue spacer **LF-b.** to the back of them. **KEEP ALL EDGES FLUSH.**

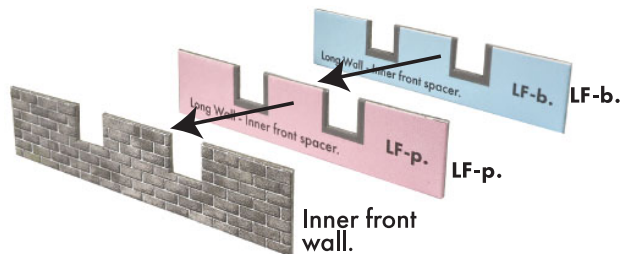

For help aligning the edges, use the Jig on the laser sheet L1.

Make the Jig.

Extract the two identical battlement jigs from the laser card L1.

Glue them together so that **ALL** edges are **ABSOLUTELY FLUSH**, this is important as this tool will help to align the layers of each battlement wall as you make them.

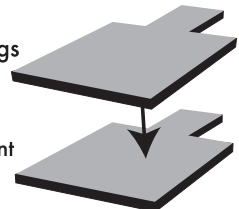

Using the Jig.

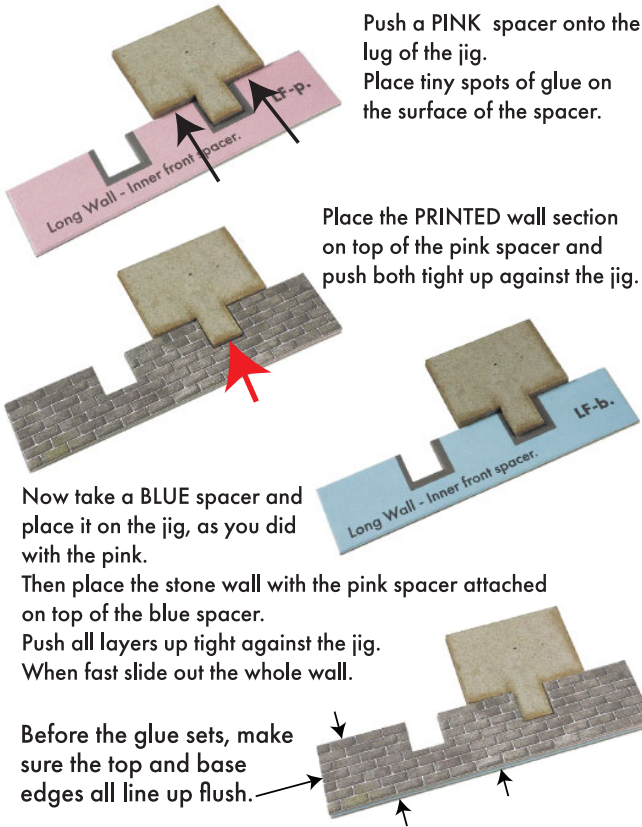

ALL THE INNER BATTLEMENTS MAKE UP THIS WAY

Now the inner rear wall fit together in the same sequence. All edges lined up flush.

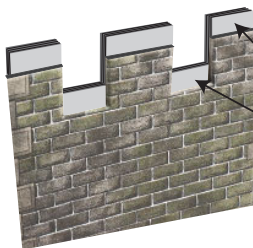
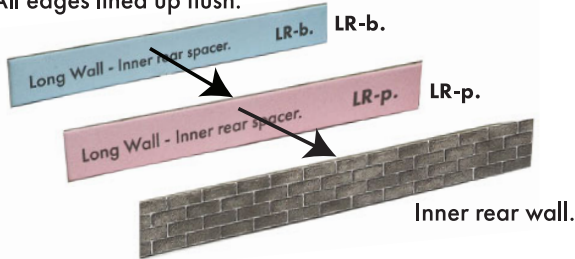

Aligning the crenels.

When fitting the inner walls to the battlements, always fit them just a little higher than the outer wall.

Then quickly before the glue dries slide them down using the point of your tweezers until they are level with the wall tops.

Slide your tweezers from side to side in the crenels as well to align the sides.

The inner walls can be slightly shorter than the outer walls. Always line them up along the top edge.

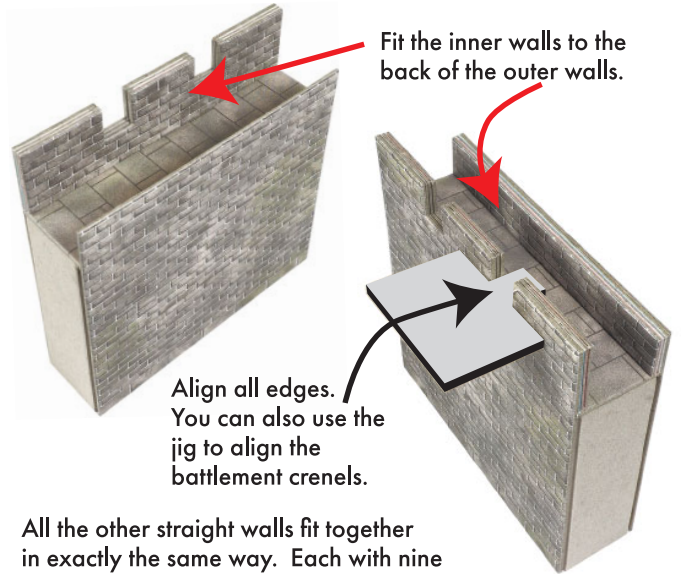
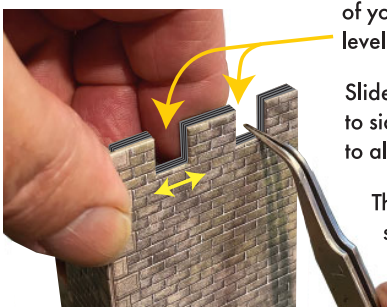

All the other straight walls fit together in exactly the same way. Each with nine components that fit to either side of their inner box.

Carefully extract the components for the Short Wall, and then the Medium Wall (all located on sheet A.) and build them up.

The EXTRA LONG WALL is slightly different in that it has two inner G1. strengthening boxes.

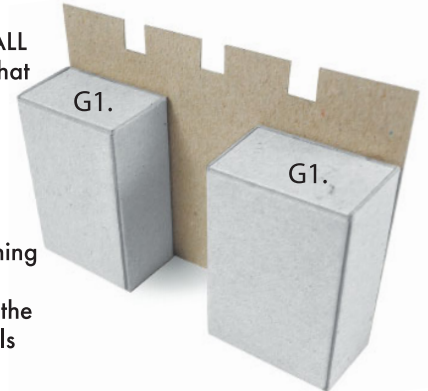

This allows for shortening the wall if needed. Everything else is just the same as the other walls

All components for the Extra Long Wall are on SHEET B.

12 The Corner Walls.

There are two 45° corner walls and one 90°

Start with the 90° Corner.

From SHEET B Extract: 18 components on bottom right hand corner of sheet.

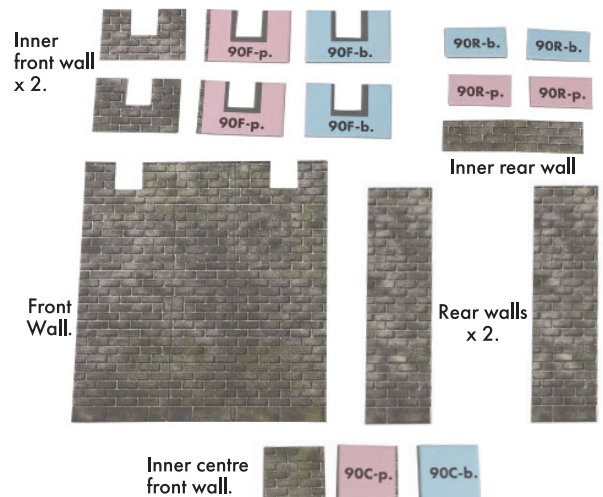
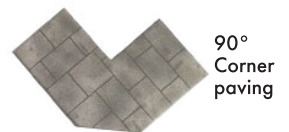

Wrap the front wall around the 90° inner strengthener.

Hold tight until glue sets

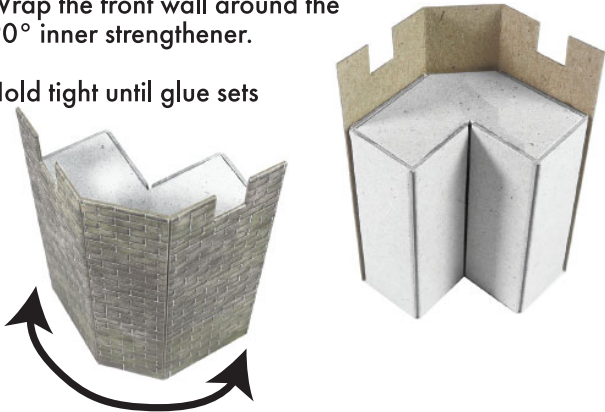

There are two inner walls. One is slightly wider than the other (only by 1 mm.). Fix this wider wall to the inside edge here flush to this edge.

NOTE: The bottom edge with the bigger stones.

Fit the other inner wall to this side in the same way.

Drop in the corner paving

Fix the two PINK 90R-p. spacers to the back of the rear walls

Then fit the two BLUE 90R-b. spacers onto the pink spacers.

Finally fit the inner rear wall.

Make up the three layers of the inner front walls, as described in section 11. Using the Jig to align the pink spacer 90F-p. with the Inner Front Wall. Then again to align the blue spacer 90F-b.

Fit to the back of the front walls with Crenels aligned.

Also align them flush with the outer wall tops.

The small Centre Front Wall is fixed to its Pink and Blue spacers, as shown here. All edges aligned flush.

It will need trimming a little down one side to get it to slide down snugly between the other two inner walls.

The 45° Corner Wall.

There are two 45° Corner Walls in this kit. Each one is made from the following components.

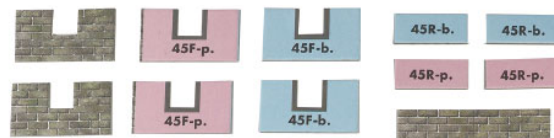

Inner front walls and spacers x 2.

Inner rear wall and spacers.

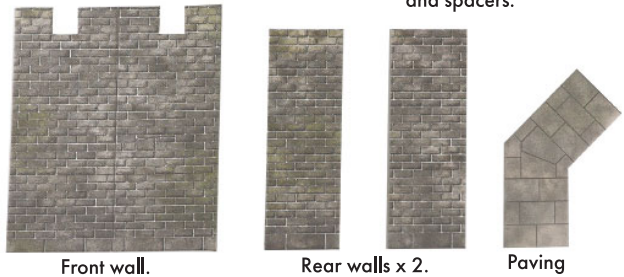

Front wall.

Rear walls x 2.

Paving

These components are located on both sheets A & B.

There is also a Wall End and three inner wall sections to go with it. Place these to one side.

Sort the two sets of components out before you start.

The instructions for the 45° corner wall are almost the same as the 90° wall. But they are repeated anyway just so you are clear.



Wrap the front wall around the 45° inner strengthener.

Hold tight until glue sets

Fix the corner paving

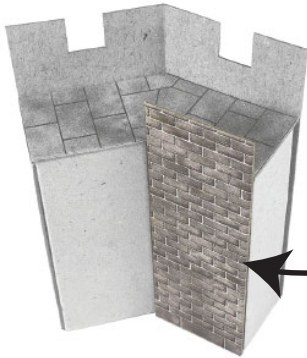
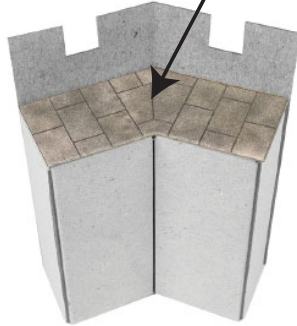

There are two inner walls. One is slightly wider than the other (only by 1mm.). Fix this wider wall to the inside edge here flush to this edge.

Fit the other inner wall to this side in the same way.



Fix the two PINK 45R-p. spacers to the back of the rear walls

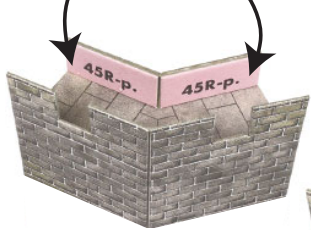

Then fit the two BLUE 45R-b. spacers onto the pink spacers.

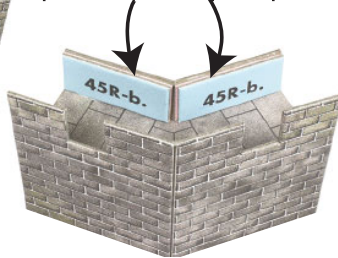

Finally fit the inner rear wall.



The inner front walls go together as before in three layers.

Align with Crenels and wall tops.

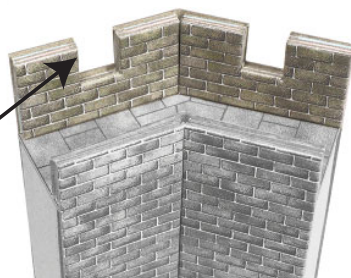

Now it's time to fit the capping stones.

Go to page 7. for details.



13 The Wall Ends.

Walls don't always go all around and join up.

Sometimes they just come to a halt.

So this wall end just makes things look tidier.

The wall end piece wraps around your wall end.

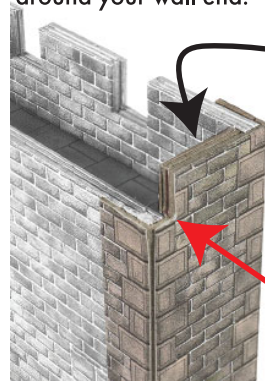
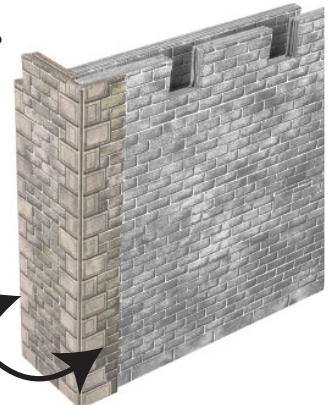

Glue the three small inner wall sections together and fit to the back of the wall end.

Then with a sharp knife cut away the corner of the wall flush to the inner wall and down to the level of the rear wall.

Corner stones.

End stones.

From Laser Sheert L1. carefully push out this top stone strip

Cut end stones off here.

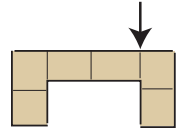

Fix onto wall tops as shown before you fit any other top stone strips.

14 The Capping Stones.

The various capping stones are the final bits that make these walls look really good. Follow the instructions carefully and you won't get lost.

It is self apparent where each stone fits as shown on the plan.

Start with the Crenel stones shaped like this:

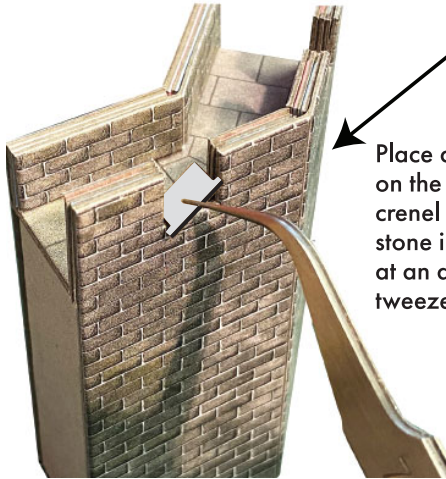

Place a tiny spot of glue on the bottom of the crenel and lift the top stone into the opening at an angle with your tweezers.

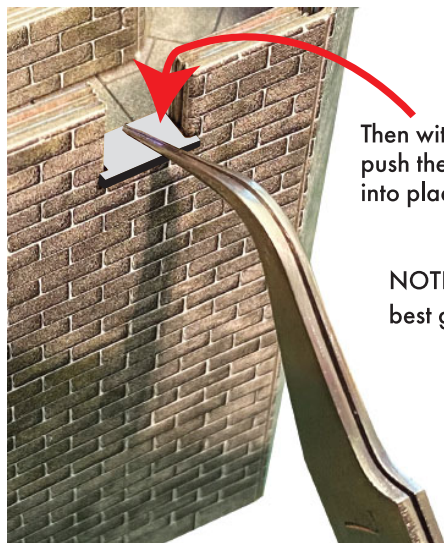

Then with the end of your tweezers push the top stone down level and into place.

NOTE: We find that Rocket Card Glue is the best glue for fitting these tiny components.

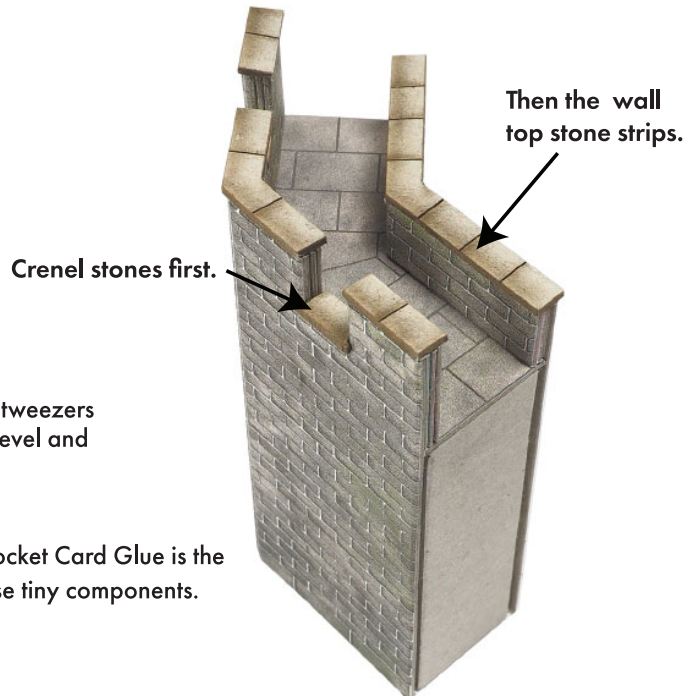
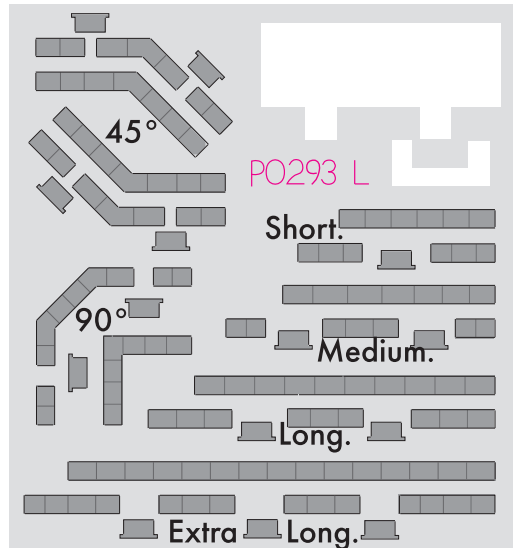

Crenel stones first.

Then the wall top stone strips.

Other kits in the Castles range.



PO294 Castle Hall

The beating heart of the castle. Or could be a stand alone country house. see above for ideas.



PO291 Castle Gatehouse

PO292 Watch Tower

A useful little tower to fit in with the curtain walls

Or even a stand alone folly

There are many variations of castles you can make with these kits.

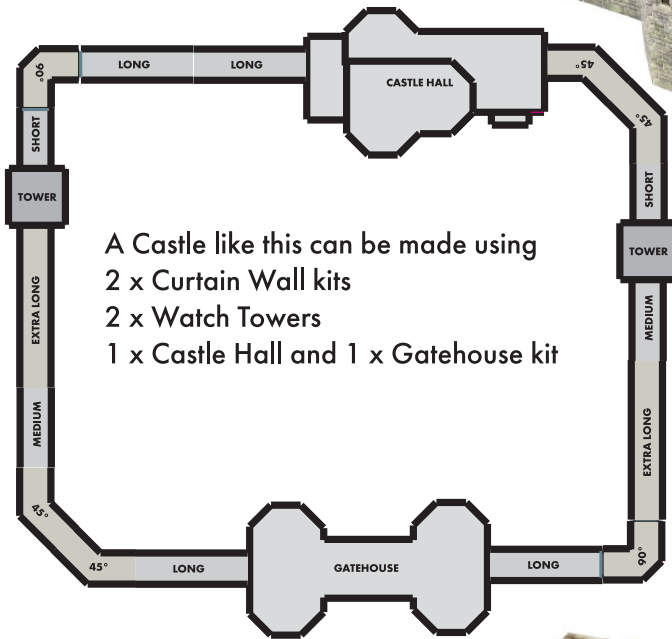
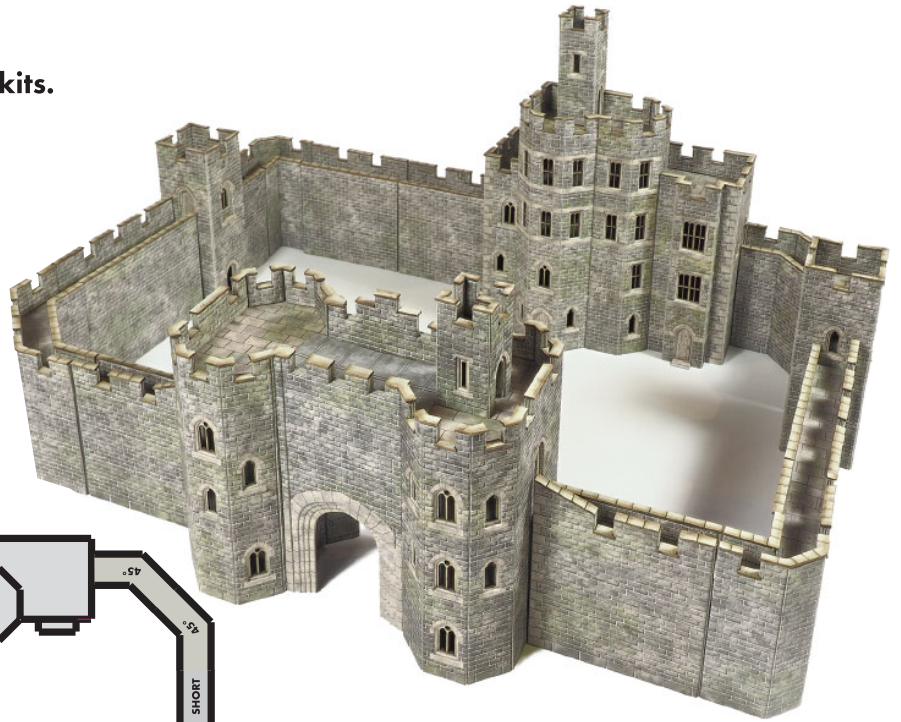

A Castle like this can be made using
 2 x Curtain Wall kits
 2 x Watch Towers
 1 x Castle Hall and 1 x Gatehouse kit

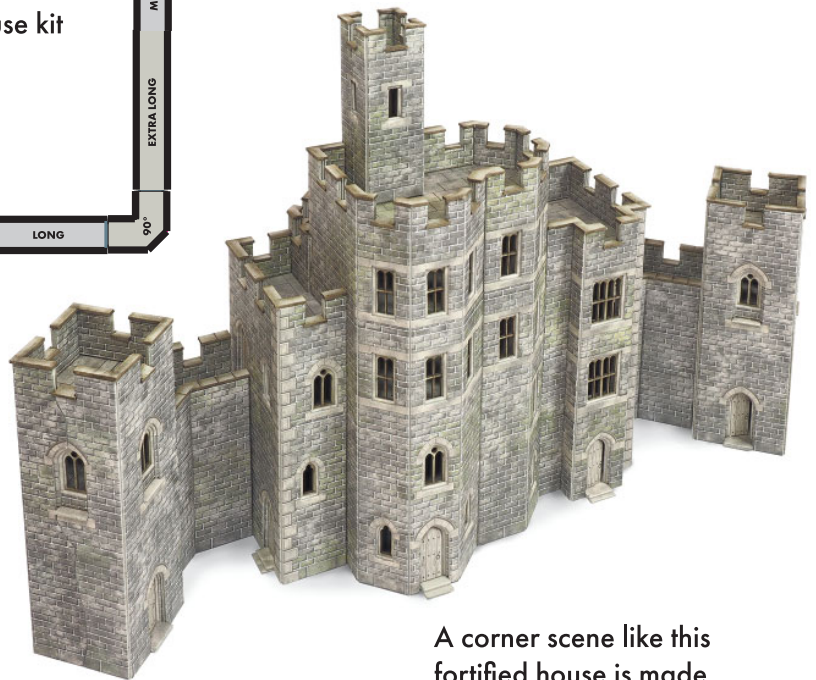

A corner scene like this fortified house is made using the Castle Hall PO294 with two 45° corners and two Watch Towers PO292.



The Gate house can be made into a part of a town or city wall using just a few bits of wall with the odd watch tower.